

Compact Vacuum Ejectors

Compact Vacuum Ejectors MCP

Suction capacity: 37 L/min to 200 L/min

Compact Vacuum Ejectors MCP



System Design Compact Vacuum Ejectors MCP

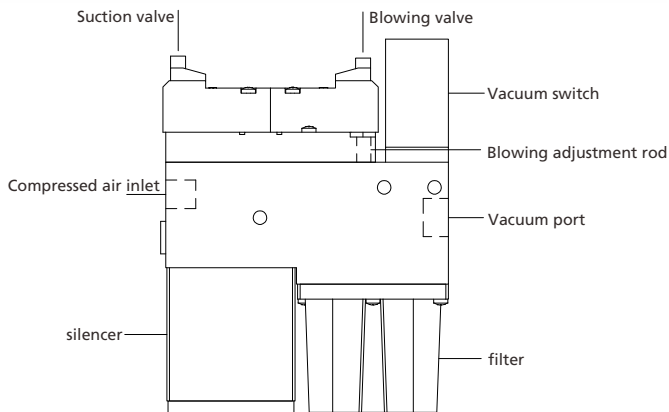

Introduction and application

- ◆ For handling airtight or micro-breathable workpieces in electronics, electrical engineering, packaging technology, robotics and the automotive industry

Design

- ◆ Body made of aluminum
- ◆ Optional suction valve normally open (NO) or normally closed (NC) form
- ◆ Built-in normally closed (NC) blow valve, filter, silencer and check valve
- ◆ Alternate component: digital vacuum switch

Ordering Data Compact Vacuum Ejectors MCP

Type	Nozzle size [mm]	Initial state of the blow valve	Blow valve and safety valve	System monitoring
MCP 10...	10=1.0mm	NC [normally closed] NO [normally open]	AS [Blow valve and safety check valve]	VD [Digital vacuum switch]
MCP 15...	15=1.5mm			
MCP 20...	20=2.0mm			
MCP 25...	25=2.5mm			
MCP 30...	30=3.0mm			

Combined Suction Cups

Vacuum Suction Cups

Composite Suction Cups

Special Grippers

Vacuum Gripping Systems

Mounting Elements

Vacuum Generators

Valve Technology

Switch And Monitoring

Vacuum Filters

Compact Vacuum Ejectors



Compact Vacuum Ejectors MCP

Suction capacity: 37 L/min to 200 L/min

Ordering Data Compact Vacuum Ejectors MCP

MCP 10...		MCP 15...		MCP 20...	
Type	Ordering Data	Type	Ordering Data	Type	Ordering Data
MCP 10 NO AS	90.05.01.00001	MCP 15 NO AS	90.05.01.00011	MCP 20 NO AS	90.05.01.00021
MCP 10 NC AS	90.05.01.00002	MCP 15 NC AS	90.05.01.00012	MCP 20 NC AS	90.05.01.00022
MCP 10 NO AS VD	90.05.01.00005	MCP 15 NO AS VD	90.05.01.00015	MCP 20 NO AS VD	90.05.01.00025
MCP 10 NC AS VD	90.05.01.00006	MCP 15 NC AS VD	90.05.01.00016	MCP 20 NC AS VD	90.05.01.00026

MCP 25...		MCP 30...	
Type	Ordering Data	Type	Ordering Data
MCP 25 NO AS	90.05.01.00031	MCP 30 NO AS	90.05.01.00041
MCP 25 NC AS	90.05.01.00032	MCP 30 NC AS	90.05.01.00042
MCP 25 NO AS VD	90.05.01.00035	MCP 30 NO AS VD	90.05.01.00045
MCP 25 NC AS VD	90.05.01.00036	MCP 30 NC AS VD	90.05.01.00046

Ordering Data Accessories Compact Vacuum Ejectors MCP

Type	Solenoid valve connection nipple	Replaced silencer	Replacement filter cartridge
MCP 10 NO/NC AS	90.90.19.00005	90.05.03.00030	90.05.03.00027
MCP 10 NO/NC AS VD	90.90.19.00005	90.05.03.00030	90.05.03.00027
MCP 15 NO/NC AS	90.90.19.00005	90.05.03.00030	90.05.03.00027
MCP 15 NO/NC AS VD	90.90.19.00005	90.05.03.00030	90.05.03.00027
MCP 20 NO/NC AS	90.90.19.00005	90.05.03.00009	90.05.03.00005
MCP 20 NO/NC AS VD	90.90.19.00005	90.05.03.00009	90.05.03.00005
MCP 25 NO/NC AS	90.90.19.00005	90.05.03.00034	90.05.03.00005
MCP 25 NO/NC AS VD	90.90.19.00005	90.05.03.00034	90.05.03.00005
MCP 30 NO/NC AS	90.90.19.00005	90.05.03.00034	90.05.03.00005
MCP 30 NO/NC AS VD	90.90.19.00005	90.05.03.00034	90.05.03.00005

Technical Data Compact Vacuum Ejectors MCP

Type	Noise level suction [dB]	Noise level free [dB]	operating pressure [bar]	Recomm. internal hose diameter compressed air [mm]	Recomm. internal hose diameter vacuum [mm]	Weight [g]	Operating temperature [°C]
MCP 10...	66	68	5	2	4	275	0...45
MCP 15...	68	68	5	4	6	275	0...45
MCP 20...	76	78	5..6	4	9	465	0...45
MCP 25...	72	82	5..6	6	9	485	0...45
MCP 30...	82	82	5..6	9	11	485	0...45

Type	Nozzle size [mm]	Vacuum [%]	Maximum suction capacity [l/min]	Suction capacity [m³/h]	Air consumption suction [l/min]	Air consumption suction [m³/h]	Maximum air consumption suction [l/min]
MCP 10...	1.0	85	37	2.2	53	3.2	200
MCP 15...	1.5	85	65	3.9	117	7.0	200
MCP 20...	2.0	85	116	7.0	190	11.4	200
MCP 25...	2.5	85	161	9.7	310	18.6	200
MCP 30...	3.0	85	200	12.0	420	25.2	200

Compact Vacuum Ejectors



Compact Vacuum Ejectors MCP

Suction capacity: 37 L/min to 200 L/min

Performance curve Compact Vacuum Ejectors MCP

Vacuum ranges for various operating pressures

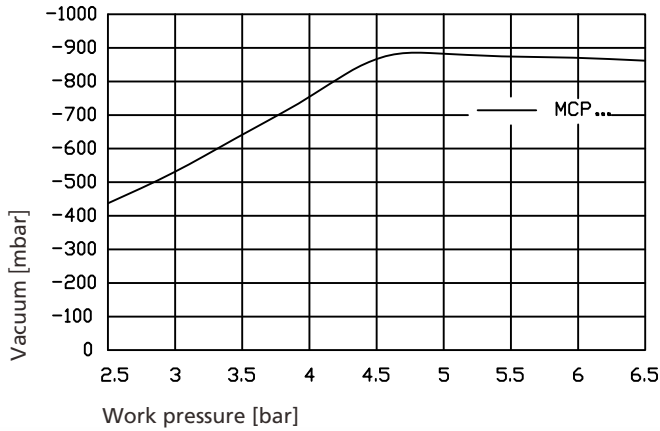

Suction times for various vacuum ranges

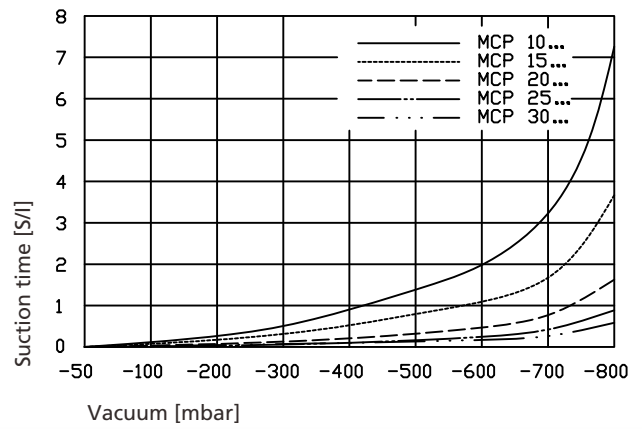

Suction capacity for various vacuum ranges

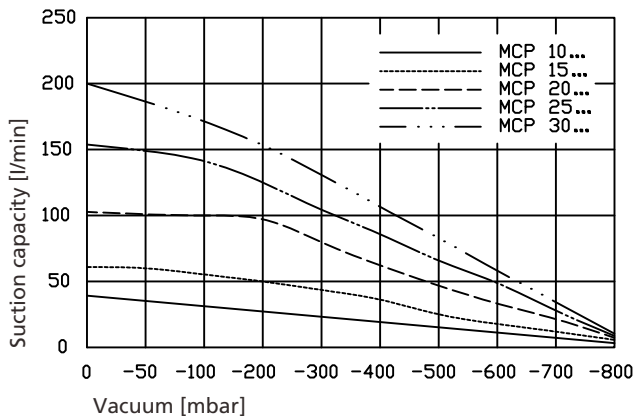

Suction capacity for various vacuum ranges [l/min]

Type	Vacuum [mbar]									
	0	-50	-100	-200	-300	-400	-500	-600	-700	-800
MCP 10...	37.0	35.4	33.2	28.8	24.0	19.4	16.0	11.2	6.0	1.4
MCP 15...	65.0	62.0	58.0	50.0	41.0	32.0	21.0	16.0	9.0	4.0
MCP 20...	116.0	108.0	101.0	90.0	78.0	63.0	48.0	36.0	18.0	5.0
MCP 25...	161.0	149.0	136.0	123.0	107.0	86.0	66.0	49.0	25.0	7.0
MCP 30...	200.0	184.0	168.0	153.0	132.0	107.0	82.0	61.0	31.0	9.0

Suction capacity for various vacuum ranges [s/l]

Type	Vacuum [mbar]									
	-50	-100	-200	-300	-400	-500	-600	-700	-800	
MCP 10...	0.087	0.162	0.341	0.591	0.959	1.419	2.035	3.304	7.300	
MCP 15...	0.048	0.088	0.184	0.311	0.480	0.744	1.120	1.692	3.606	
MCP 20...	0.026	0.047	0.095	0.159	0.239	0.349	0.499	0.807	1.652	
MCP 25...	0.015	0.027	0.055	0.089	0.135	0.198	0.288	0.486	0.960	
MCP 30...	0.012	0.021	0.044	0.071	0.108	0.160	0.232	0.392	0.810	

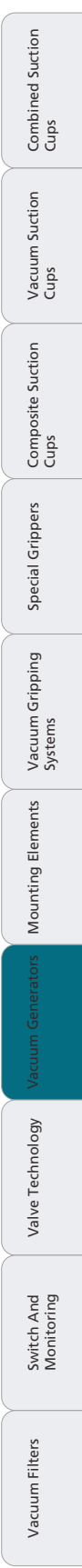

Compact Vacuum Ejectors



Compact Vacuum Ejectors MCP

Suction capacity: 37 L/min to 200 L/min



Design Data Compact Vacuum Ejectors MCP

MCP 10 to 15 NC/NO AS

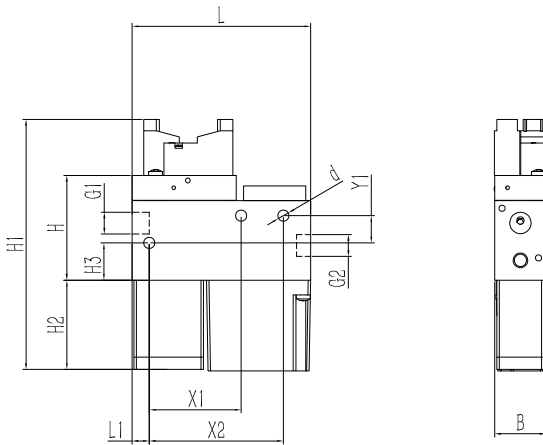

MCP 10 to 15 NC/NO AS VD

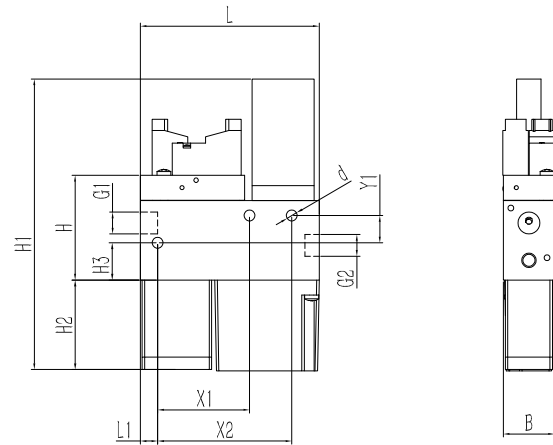

MCP 20 to 30 NC/NO AS

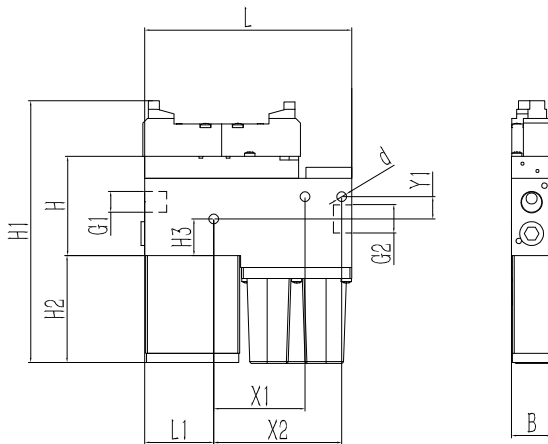

MCP 20 to 30 NC/NO AS VD

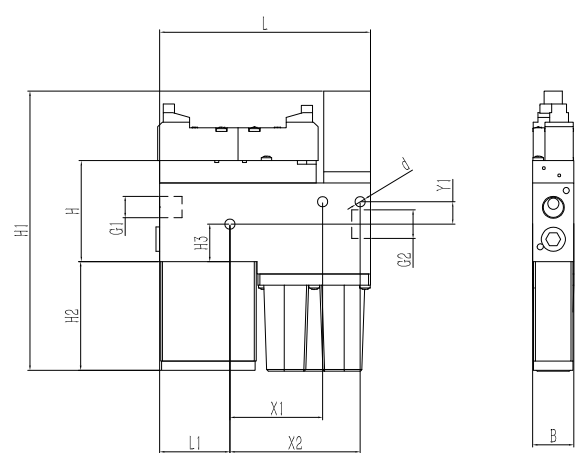

Type	Dimensions [mm]												
	B	d	G1	G2	H	H1	H2	H3	L	L1	X1	X2	Y1
MCP 10 NC/NO AS	20.6	4.5	G1/8"-F	G1/8"-F	42.2	100.5	36.5	15.0	72.0	7.0	37.0	54.0	11
MCP15 NC/NO AS	20.6	4.5	G1/8"-F	G1/8"-F	42.2	100.5	36.5	15.0	72.0	7.0	37.0	54.0	11
MCP 20 NC/NO AS	22.0	5.5	G1/4"-F	G3/8"-F	54.0	142.5	58.5	20.0	112.5	37.5	49.5	69.5	12
MCP 25 NC/NO AS	22.0	5.5	G1/4"-F	G3/8"-F	54.0	157.5	73.5	20.0	112.5	37.5	49.5	69.5	12
MCP 30 NC/NO AS	22.0	5.5	G1/4"-F	G3/8"-F	54.0	157.5	73.5	20.0	112.5	37.5	49.5	69.5	12
MCP 10 NC/NO AS VD	20.6	4.5	G1/8"-F	G1/8"-F	42.2	117.5	36.5	15.0	71.5	7.0	37.0	54.0	11
MCP 15 NC/NO AS VD	20.6	4.5	G1/8"-F	G1/8"-F	42.2	117.5	36.5	15.0	71.5	7.0	37.0	54.0	11
MCP 20 NC/NO AS VD	22.0	5.5	G1/4"-F	G3/8"-F	54.0	149.5	58.5	20.0	112.5	37.5	49.5	69.5	12
MCP 25 NC/NO AS VD	22.0	5.5	G1/4"-F	G3/8"-F	54.0	164.5	73.5	20.0	112.5	37.5	49.5	69.5	12
MCP 30 NC/NO AS VD	22.0	5.5	G1/4"-F	G3/8"-F	54.0	164.5	73.5	20.0	112.5	37.5	49.5	69.5	12

- Combined Suction Cups
- Vacuum Suction Cups
- Composite Suction Cups
- Special Grippers
- Vacuum Gripping Systems
- Mounting Elements
- Vacuum Generators
- Valve Technology
- Switch And Monitoring
- Vacuum Filters